

Subject to change without prior notice

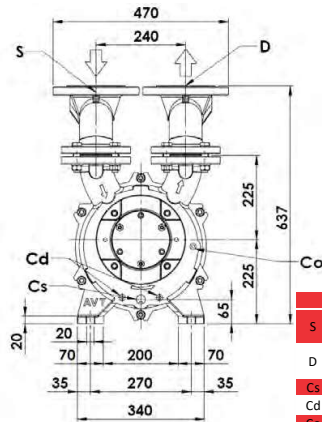

CONNECTIONS		
S	Gas inlet	ND 100/4"
D	Gas outlet	ND 100/4"
Cs	Service liquid inlet	G 3/4"
Cd	Pump drain	G 3/8"
Co	Overflow	G 3/8"

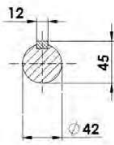
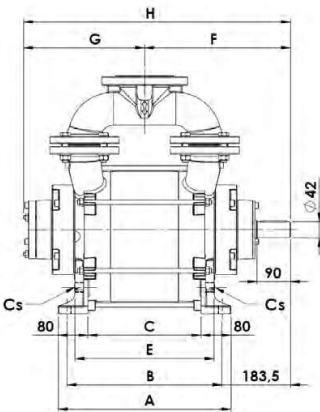
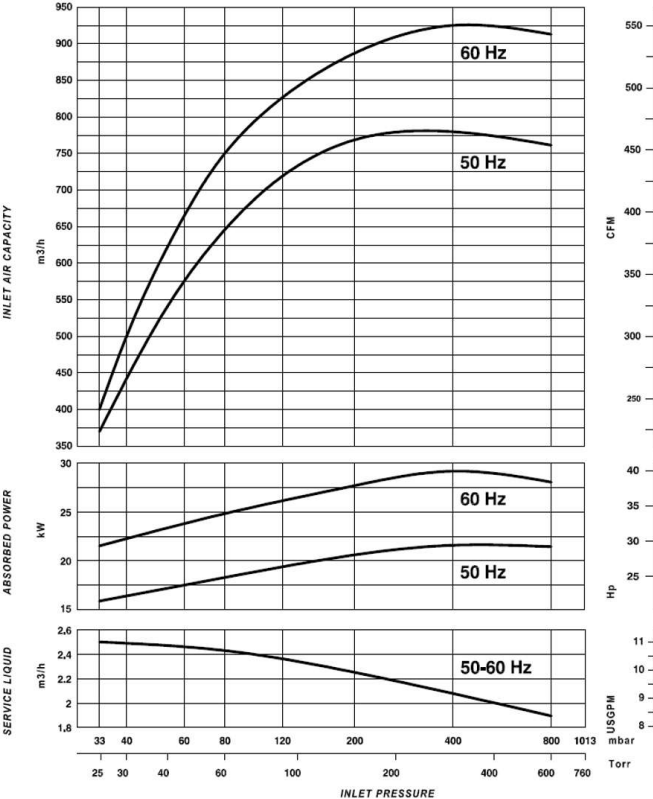

NOTES :
The given data are referred to dry air at the temperature of 20°C, at the atmospheric discharge pressure (1013 mbar), and of supply of service water at 15°C temperature.
Performances tolerance ±10%.

PRODUCT INFORMATION:
FLA 806 is a single stage liquid ring pump suitable to achieve deep vacuum (down to 33 mbar abs). This model is characterized by being bare shaft pumps, so that the device is secured by a flexible coupling that makes the pump shaft integral with the motor shaft. The reference operating speed is the 4 pole motor speed. The pumps are characterized by the presence of two big manifolds, that allow distributing/collecting the gas to/from the end casing located on both impeller ends. The shaft seal is made by means of a simple acting mechanical seal, one on each pump end.

APPLICATIONS:
Vacuum industrial processing, Sterilization, Extrusion, Degassing, Evaporation and Distillation, Priming, Vacuum sewage, Bottling, Depoultry, Fish Farming

Operating Modes

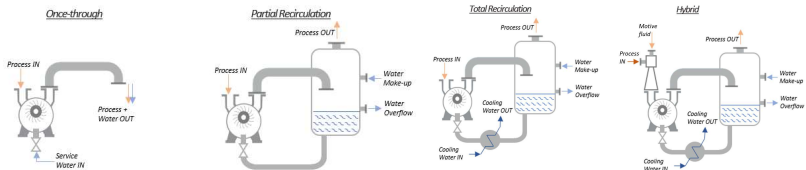

FLA 806		
Voltage		277/480V
Part Number		8502013
Nominal Capacity	CFM	529.7202
Total Final Pressure (Abs.)	Torr/inHg	24.75/.97
Motor Power	H.P.	40
Nominal r.p.m.	n/min	1750
Noise Level	dB(a)	76
Weight	Lbs.	551
Max Gas Temperature		212° F

(*) Please contact the Manufacturer if environmental conditions are different from those indicated.

